

HRFE

Contour™ Barrier-Free Fountain

MOUNTING INSTRUCTIONS

Refer to diagrams for rough-in of plumbing. For wall support required locations see installation instructions provided with fountain. Water service line and waste line are to be assembled as required. Final check for leaks and correct functions of fountain should be made. (For details see the installation instructions.)

CAUTION — Fountain must be securely bolted to wall.

OPERATING PRESSURES:

Supply water - 105 psi maximum

FRONT VIEW

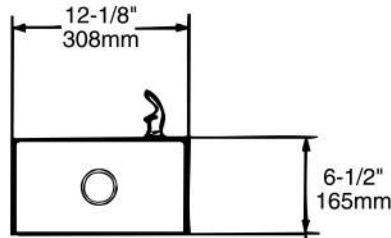

SIDE VIEW

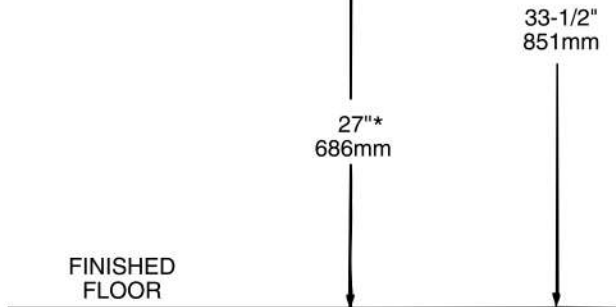
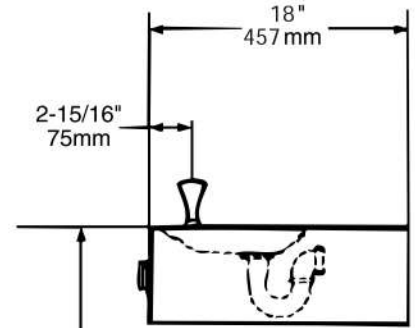

*ADA Requirement

TOP VIEW

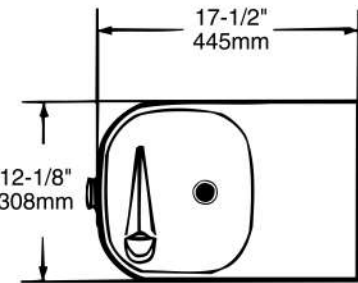

WALL LAYOUT

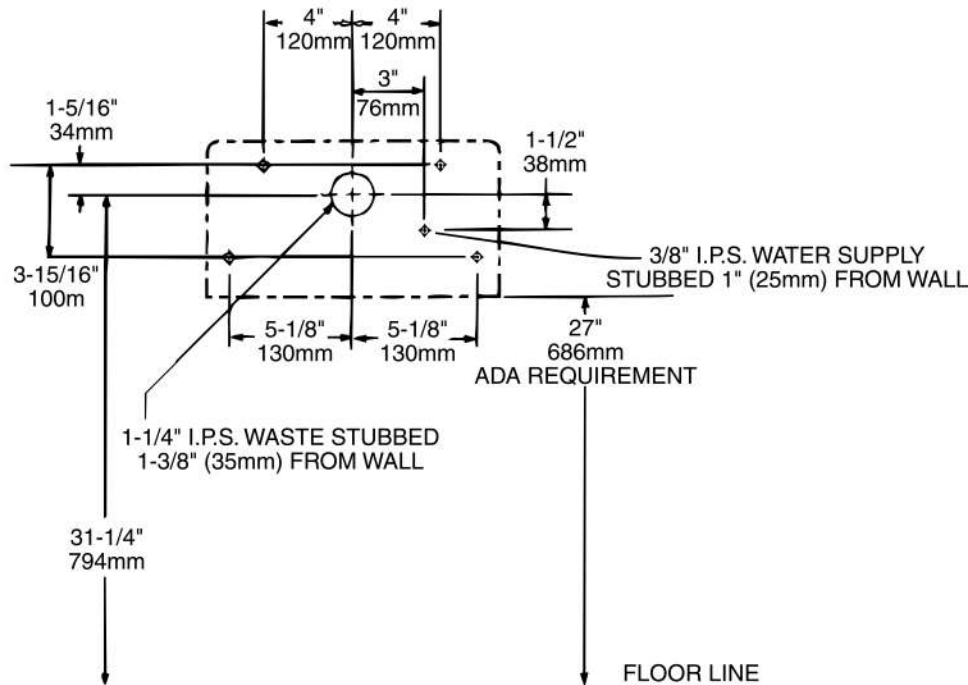

Note: A service supply stop (not included) must be installed at the fountain inlet line.
1-1/4" Trap provided.