

ShowerLite

Installation Instructions



ShowerLite LED Back-lit, Fog-free Shower Mirrors

Models 16104-1212, 1224, 1818 & Custom. 3K and 5K Color
April 2022

The ShowerLite ClearMirror is UL/C-UL listed for use in the shower and tested to CSA standards. This unit is designed to be powered by a switched outlet and activated when the bathroom light or fan is switched on.

IMPORTANT INSTRUCTIONS

Only wire the ShowerLite to the 24-volt DC direct plug-in power supply included with this product. Install in accordance with all applicable safety, national and local electrical codes. **Read all instructions before using the ShowerLite ClearMirror.**





NOTICE: All installation wiring must be performed by a licensed electrician. Follow the National Electrical Code, local codes, NFPA 70-2011 as applicable.



NOTICE: Only use the power supply included with this product. No replacement power supplies should be used.



NOTICE: All wiring including new receptacles, must be performed by a licensed electrician. Follow the National Electrical Code or local codes as applicable.



WARNING: Direct plug-in power supply must be placed in a dry location outside of the shower. Outlet used must be at least three feet from the shower. Follow NEC Article 406. Failure to follow instructions could result in death or serious injury.

General Guidelines

- Extreme caution is necessary when any heater is left operating and unattended.
- Do not operate any heater after it malfunctions. Disconnect power at service and have heater inspected by a reputable electrician before reusing.
- Do not use outdoors.
- To disconnect heater, turn controls to off using light/fan/receptacle switch, and turn power off to circuit at the main disconnect panel.
- Use this heater only as described in this manual. Any other use not recommended by the manufacturer may cause fire, electric shock, or injury to persons.
- Do not install on un-insulated exterior walls in cold climate areas.
- Do not install if product is damaged.
- Do not bend, cut, alter, submerge in water, or use for purposes other than described.
- Mirror must be caulked or grouted into tile, flush with the tile surface. Edges of the mirror cannot be exposed to touch.
- Contact ClearMirror for LED replacement parts.
- Consult the NEC, Article 551 for rec. vehicle installation.
- **SAVE THESE INSTRUCTIONS.**

Installation

1. Before installing ceramic tile, measure for desired ShowerLite height from the finished shower floor.
2. Prepare an area for the outside dimensions of the mirror adjusting for your grout lines as needed.
3. Measure & mark the location of the mirror.
4. If needed, remove the marked area of wallboard to allow the mirror to install flush with the tile (see Figure 1).

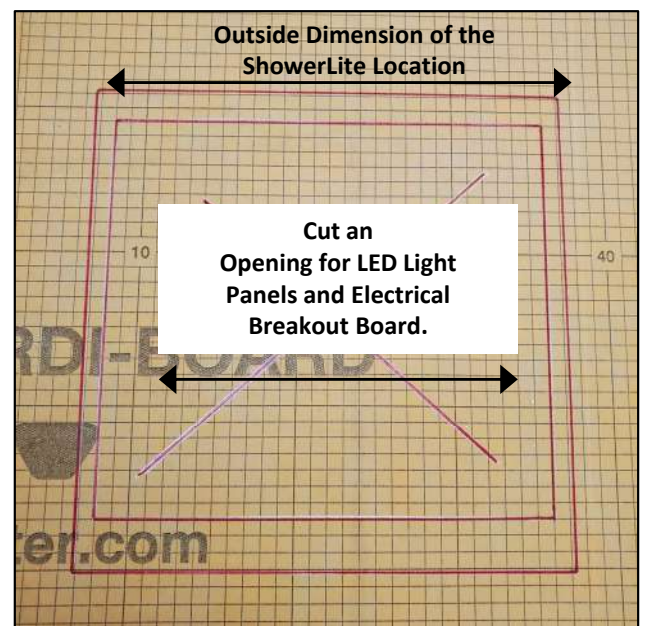

Figure 1. Preparing the wall board (front view).



WARNING: This stage requires a qualified electrician and conformance with both the National Electrical Code and local building codes. Turn off the power to the circuit connected to the light fixture at the disconnect means. Failure to do so could result in death or serious injury.

WIRING

The ShowerLite uses a custom power breakout board to receive power and connect LEDs and heater. Maximum distance from mirror to the LED driver is 40 ft. Driver also has a 5 ft. AC cord with plug.

The power supply is **plugged into a switched outlet**. The outlet is either dedicated for the ShowerLite or tied into another switched light in the bathroom.

1. Run power supply wire from the provided low-voltage plug-in power supply to the opening at the mirror location. The 24V power supply wire is 40-foot long and runs through the wall.
2. Before mounting the mirror, connect the power to the breakout board and test LEDs and heater.

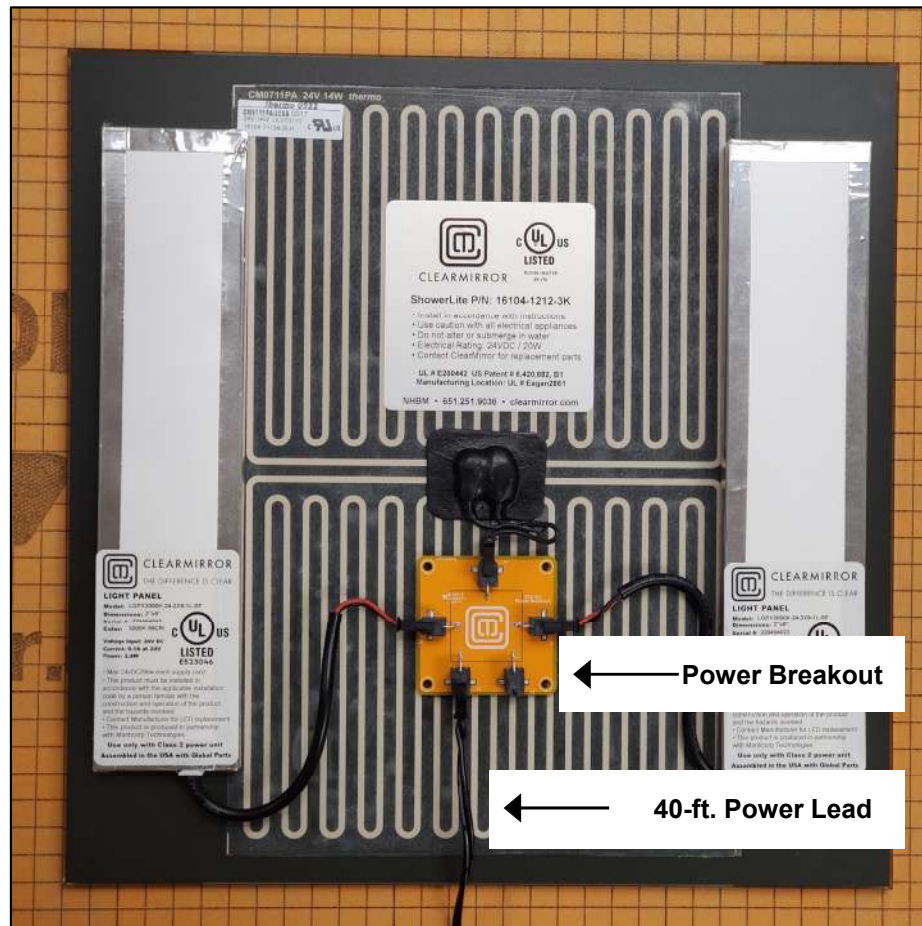

Figure 2. Power breakout board and power supply lead.



NOTICE: Use only supplied connection wiring between the mirror and the outlet. All wiring must be in accordance with applicable installation code, NFPA 70-2011, National Electric Code.

The direct plug-in power supply must be accessible for service and replacement and must have some air flow. Do not mount the power supply in a closed wall. Common locations include: cabinets, closets, attics and adjoining rooms. The direct plug-in power supply is plugged in to a switched outlet.



NOTICE: This stage may require two people. One to hold the mirror and another to connect the power wire.

MOUNTING THE MIRROR

1. One person holds the mirror while another connects the power cord to the breakout board.
2. Test to make sure LEDs and the heater are working. It takes 3 to 5 minutes to heat the mirror.
3. Apply mirror mastic adhesive to the mirror back on areas that will contact the wall board. It is safe to apply mastic on the heater.
4. Apply a **continuous bead around the entire edge** perimeter to fully seal and protect the mirror, as shown in Figure 3.
5. Carefully mount to the wall.
6. Securely **tape and brace the mirror in place for 24 to 48 hours or until dry.**

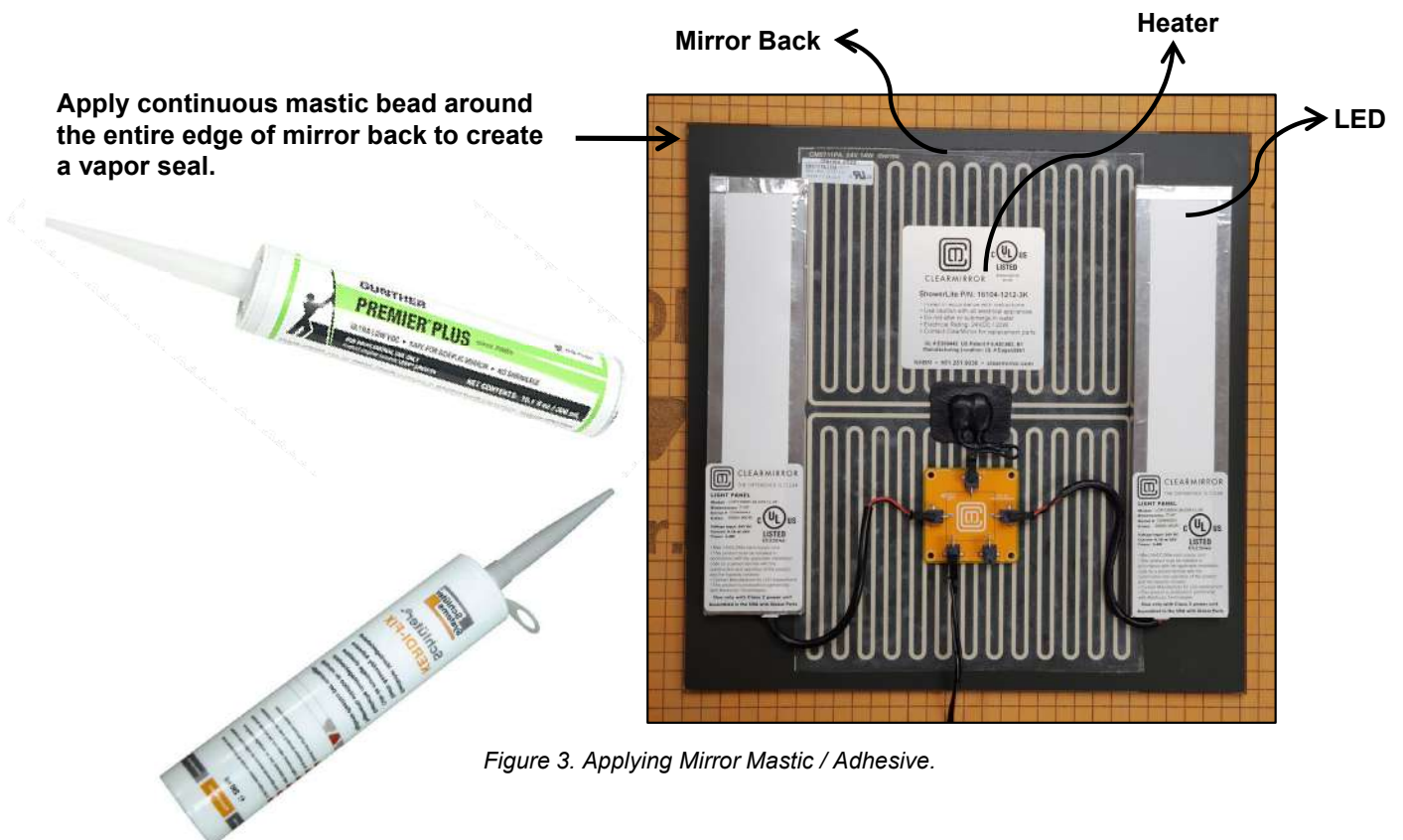

Figure 3. Applying Mirror Mastic / Adhesive.

Use Premium Mirror Mastic for Best Results

To prevent damage to the mirror backing, use Gunther Premier Plus Mirror Mastic or Kerdi Fix. Mastic is available from your local mirror/glass specialist or online through Amazon or CR Laurence. Kerdi Fix is available online or at tile shops.

Both products have a shelf life. We are not able to provide it with your shower mirror. Other mirror mastics will work but these products are recommended.



WARNING: Mirror must be completely caulked or grouted into the tile or surround and flush with tile surface. Back edge of the mirror cannot be exposed to touch. Failure to do so could result in electric shock or injury.

FINISHING THE MIRROR

Caulk or grout around the edges.

See Figure 4.



Figure 4. Grout around the mirror to seal and finish.

IMPORTANT INSTRUCTIONS

SAVE THESE INSTRUCTIONS

When using electrical appliances, basic precautions should always be followed to reduce the risk of fire, electric shock, and injury to persons, including the following:

Read all instructions before installing or using this heater.

- Do not operate any heater after it malfunctions. Disconnect power at service panel and have heater inspected by a reputable electrician before reusing.
- Do not use outdoors.
- To disconnect heater, turn bath switch to off, and turn off power to heater circuit at main disconnect panel (or operate internal disconnect switch if provided).
- Do not insert or allow foreign objects to enter any ventilation or exhaust opening as this may cause an electric shock or fire; or damage the heater.
- To prevent a possible fire, do not block air intakes or exhaust in any manner.
- Use this product only as described in this manual. Any other use not recommended by the manufacturer may cause fire, electric shock, or injury to persons.

OPERATING INSTRUCTIONS

- The ShowerLite assembly must be properly installed before it is used.
- The ShowerLite must be installed flush with the tile with wiring fed from behind the full, wall-mounted assembly.
- Be certain that the controls are operational per the instructions in that the bathroom light, ceiling fan or alternate switch power on and power off the ShowerLite.
- Do not modify the installation from within (or outside) the assembly, and do not tamper with any user-operated devices intended to reduce the risk of fire, electric shock, or injury to persons; and warn against tampering with such devices.
- Any servicing should only be done by a qualified service person.

MAINTENANCE INSTRUCTIONS

The ShowerLite requires very little user maintenance:

- Be sure the power is turned off and the heating element (mirror surface) is cool prior to performing any of these functions.
- Dampen a lint-free cloth and lightly clean the surface. Never use chlorine base, chemical glass cleaners or any abrasive material on the Mirror. Use of those cleaners or chemicals will void all warranties and guarantees. DO NOT SPRAY MIRROR. Heater and LEDs on the back of the mirror should never be accessed and require no cleaning.
- The mirror will not require internal or behind assembly cleaning.
- As necessary, clean only the surface of the mirror with an approved glass cleaner and soft cleaning cloth.
- All other servicing should be performed by qualified service personnel. Call ClearMirror directly with any warranty or operational problems or concerns.

GROUNDING INSTRUCTIONS

This ShowerLite assembly with a ClearMirror heater is for use with a 24-volt power supply and comes with a grounded cord set.

WARRANTY INFORMATION

NewHome Bath & Mirror, Inc. DBA ClearMirror and its affiliates will not warranty the labor or material costs for installation, replacement or use of ShowerLite when operated in an application that is lower than 50° F.

NewHome Bath & Mirror, Inc. and its suppliers cannot be held responsible for damage caused by improper installation. These installation instructions are to be used as a guide only while meeting all applicable building codes. Consult a professional installer if you have any questions.

The ShowerLite product line is provided with a five-year warranty against defects in workmanship or materials. Warranty only covers replacement parts only. Improper installation and/or cleaning voids the warranty. Contact your installer or original place of purchase for issues relating to installation and replacement. The warranty is void without proof of purchase, proper installation, or if product is altered in any way.



ClearMirror
2861 Eagandale Blvd • Eagan, MN 55121 • 651.251.9036
ClearMirror.com